

## 210 Non Lock - 100% Extension

Note 1: 15 mm dia. holes in centre beam allow easy access to fixing holes. M5 countersunk head screws to BS4183 are recommended for fixing.

Note 2: Elongated holes should be provided in either the framework or chassis to give adjustment if it is necessary for the panel to fit tight against the framework.

All dimensions in mm.

System Load Capacity value refers to a pair of rails.

**Extension:** 100%



## General Data

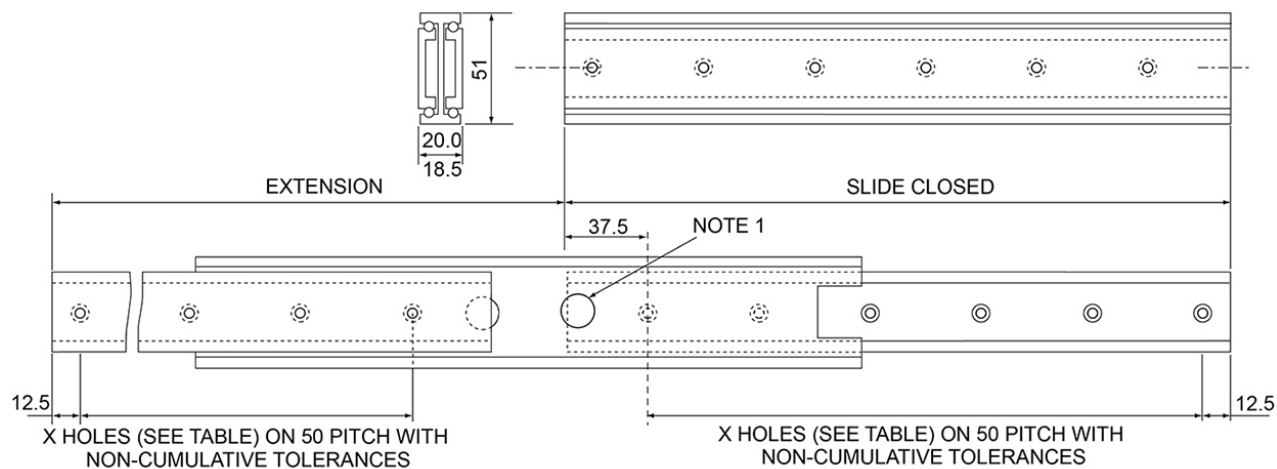

Designation	Closed Length	Extension Length	System Load Capacity (N)	Number of Fixing Holes
<b>210-300</b>	300	330	550	6
<b>210-350</b>	350	380	620	7
<b>210-400</b>	400	430	710	8
<b>210-450</b>	450	480	780	9
<b>210-500</b>	500	530	840	10
<b>210-550</b>	550	580	880	11
<b>210-600</b>	600	630	900	12